

# SLED SERIES

**Material:** LCP (Black)  
Zytel FR50 (Natural)

**Rating:** UL 94-VO

**2 Terminals:** Brass Alloy or  
Phos. Bronze  
90/10 Tin Plated

**Solderability:** Per MIL-STD-202  
Method 208

**Packaging Tray:**

STM302-2 TY50x50-A

STM372-2 TY50x50-A

STM502-2 TY74x77-A

STM602-2 TY74x77-A

**Application:** For surface mounting of inductors up to .600 inches in diameter. Designed to facilitate termination, to be robust during handling, and easy to pick and place.

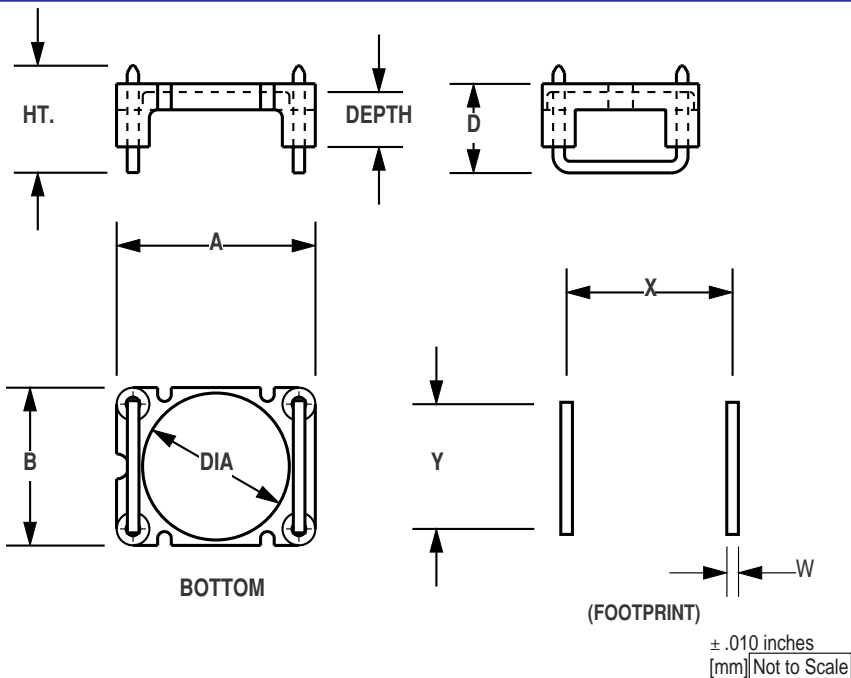

±.010 inches  
[mm] Not to Scale

PART NO.	MAT'L	HT.	DEPTH	DIA.	A	B	D	W	X	Y
STM302-2	LCP	.245 [6.22]	.120 [3.04]	.270 [6.85]	.395 [10.03]	.340 [8.63]	.190 [4.82]	.025 [0.63]	.300 [7.62]	.245 [6.22]
STM302-2/A	Zytel	.245 [6.22]	.120 [3.04]	.270 [6.85]	.395 [10.03]	.340 [8.63]	.190 [4.82]	.025 [0.63]	.300 [7.62]	.245 [6.22]
STM372-2	LCP	.320 [8.12]	.170 [4.31]	.370 [9.39]	.475 [12.06]	.420 [10.66]	.270 [6.85]	.025 [0.63]	.375 [9.52]	.320 [8.12]
STM502-2	LCP	.385 [9.77]	.180 [4.57]	.445 [11.30]	.620 [15.74]	.520 [13.20]	.315 [8.00]	.045 [1.14]	.500 [12.70]	.400 [10.16]
STM602-2	LCP	.395 [10.03]	.200 [5.08]	.530 [13.46]	.725 [18.41]	.570 [14.47]	.325 [8.25]	.045 [1.14]	.600 [15.24]	.450 [11.43]