

# HTM SERIES

## RELATIVE SHAPES

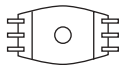

HTM 461-6



HTM 601-6

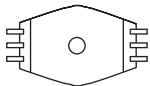

HTM 851-6

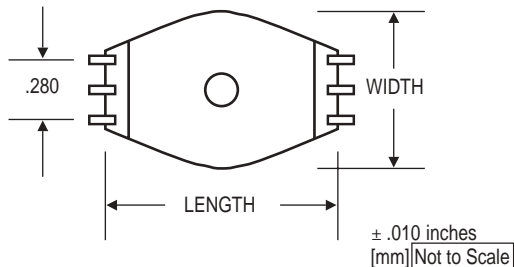
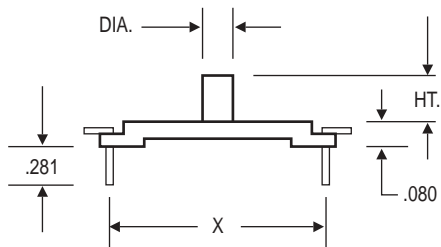

<b>Material:</b>	Nylon 6/6 (Tan)
<b>Rating:</b>	UL 94-VO
<b>6 Terminals:</b>	Brass .025 X .010 95/5 Tin Plated
<b>Solderability:</b>	Per MIL-STD-202 Method 208

**Application:** Low profile horizontal mounting of wound toroids from .400 to .850 inches in diameter. Each size is available with or without a center post.

PART NO.	LENGTH	WIDTH	HT.	DIA.	X	CORE SIZES	PACKING TRAY
HTM 460-6	.720 [18.28]	.460 [11.68]	.000	.000	.638 [16.20]	up to .500 inches	TY65-100-A
HTM 461-6	.720 [18.28]	.460 [11.68]	.163 [4.14]	.120 [3.04]	.638 [16.20]	up to .500 inches	TY65-100-A
HTM 600-6	.937 [23.79]	.600 [15.24]	.000	.000	.848 [21.53]	up to .750 inches	TY85-116-A
HTM 601-6	.937 [23.79]	.600 [15.24]	.250 [6.35]	.156 [3.96]	.848 [21.53]	up to .750 inches	TY85-116-A
HTM 850-6	1.208 [30.68]	.850 [21.59]	.000	.000	1.130 [28.70]	up to 1.00 inches	TY122-140-A
HTM 851-6	1.208 [30.68]	.850 [21.59]	.250 [6.35]	.156 [3.96]	1.130 [28.70]	up to 1.00 inches	TY122-140-A