

Core cross reference (x = material variation within a size)

Fair-Rite: 94 XX 015002	Micrometals: E100-XX	Magnetics: X-42510-EC
Nicera: FEE-25.3	Epcos: B66315	MMG:
Ferroxcube: 812E250-3 XXX	TDK: PC XX EE25.4-Z	

Winding Area (mm<sup>2</sup>)

LODESTONE PACIFIC  
**B-EE2425V-10-1-PH3**

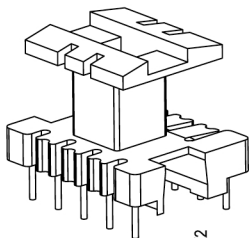

**TOP**

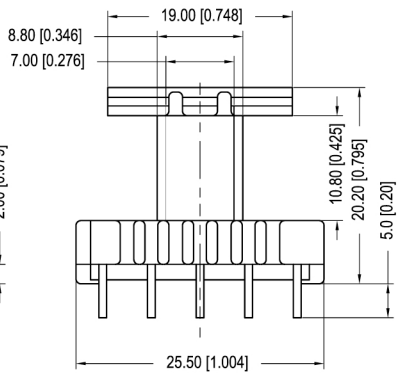
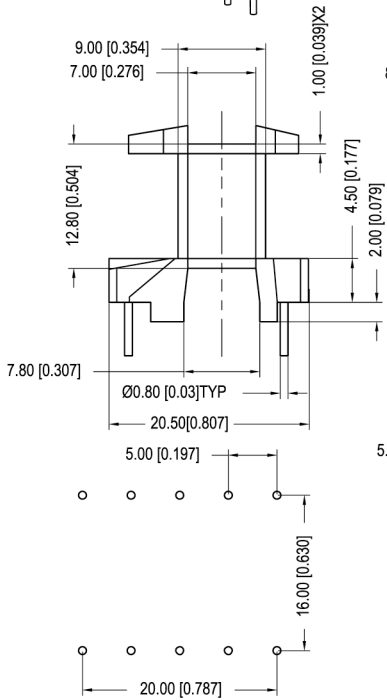
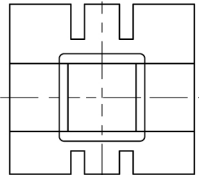

**BOTTOM**

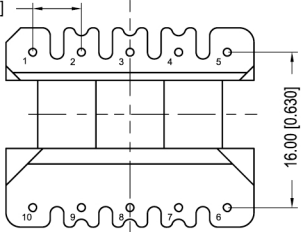

© 2006

	Scale	Tolerance (Inches)	Tolerance (mm)	No. of Terminals	Terminal Plating	Terminal Material	Terminal Type	
	None	.XXX ± .008 .XX ± .012	.XX ± 0.20 .X ± 0.30	10	100% Tin	CP WIRE	Through Hole	
<p style="text-align: center;"><b>LODESTONE PACIFIC</b></p> <p>Phone: (714)970-0900. Fax: (714)970-0800 4769 Wesley Drive, Anaheim, California, 92807, USA Web: www.lodestonepacific.com E-Mail: sales@lodestonepacific.com</p>					Molding Material	UL File No.	Rating	Class
					PHENOLIC	E59481	UL94-V0	F
Lodestone's Part Number							Rev.	
<b>B-EE2425V-10-1-PH3</b>							<b>1</b>	